



## DEUTSCHE BANK GROUP- CHANGE IN LANGUAGE PREFERENCES

The language you see on your SAP Business Network account is based on the language settings in your Internet browser. Please follow the below instructions to make changes on your browser to set your preferred language

Using Microsoft Edge:

- 1 Click '...' top right corner of your screen > Settings

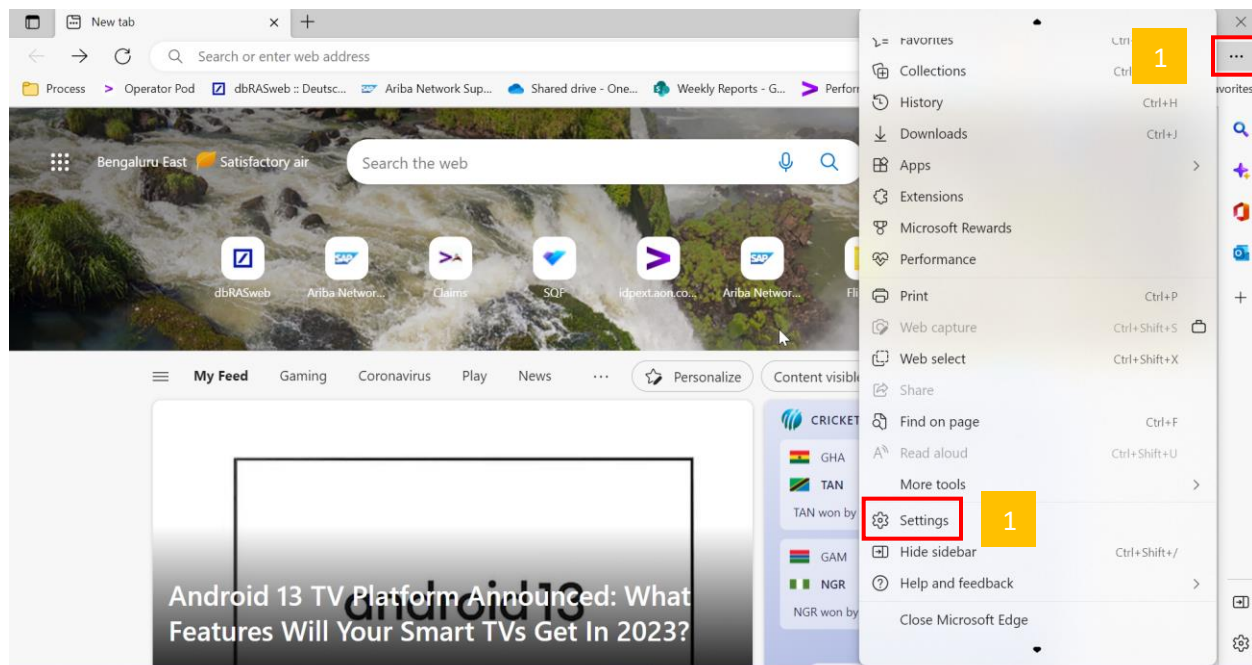

- 2 In the **Settings** window, click **Languages** to add the desired language.

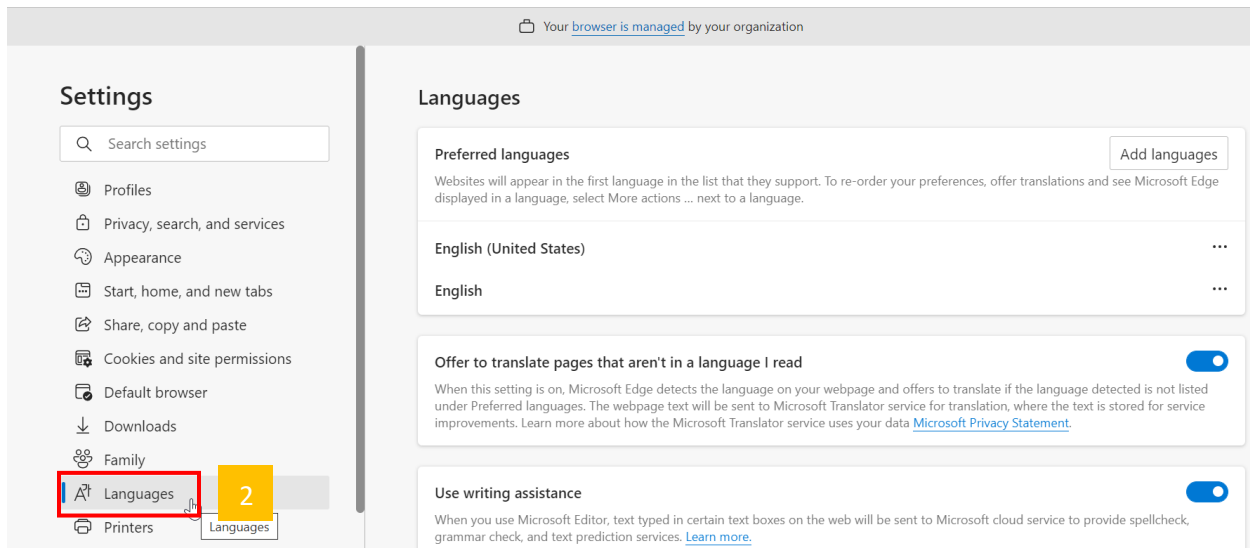

3 Select **Add Languages** > **Select your desired language**> **Click Add**

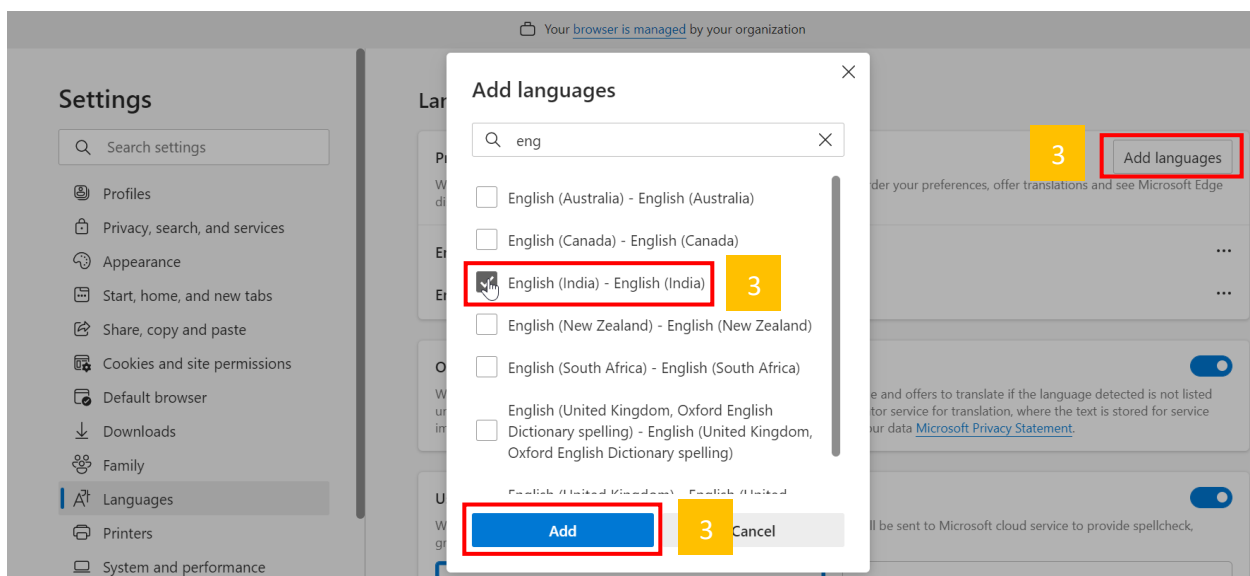

4 This language will need to be placed at the top of the list using the **Move to the top** button.

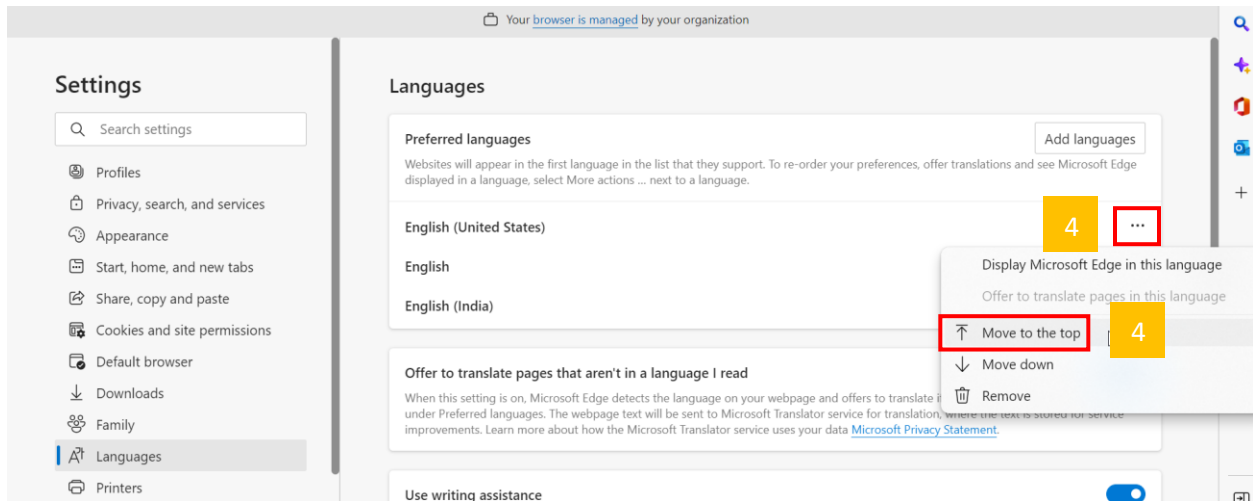

Next, close your browser and reopen it for the changes to take effect. If the language you select is not supported by SAP Business Network, it defaults to English.

### Using Google Chrome:

- 1 Click the options menu in the upper right corner and choose **Settings**.

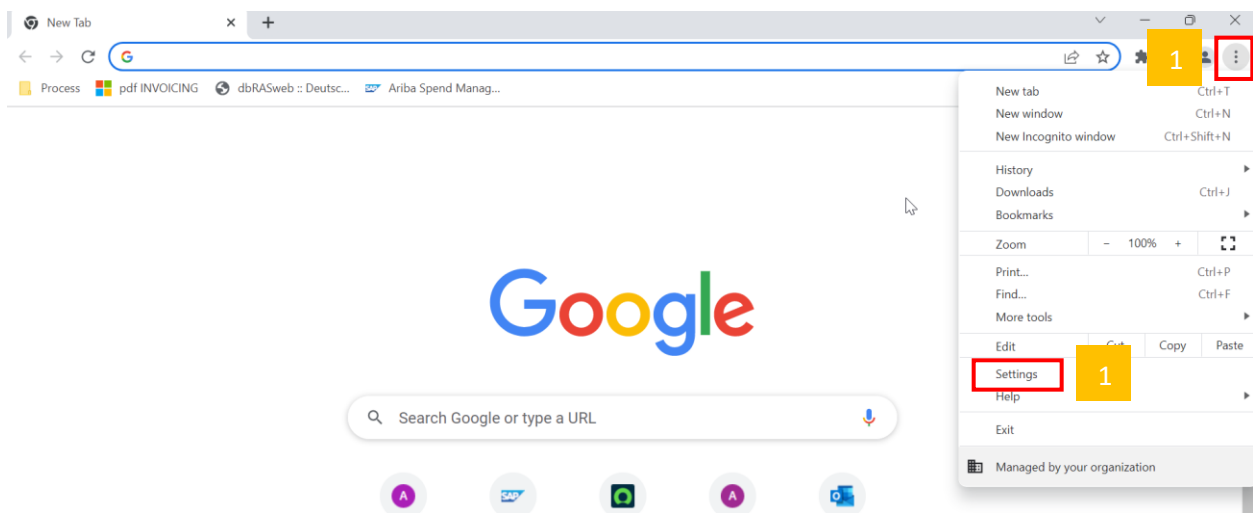

2

In the **Settings** window, click **Languages** to add the desired language.

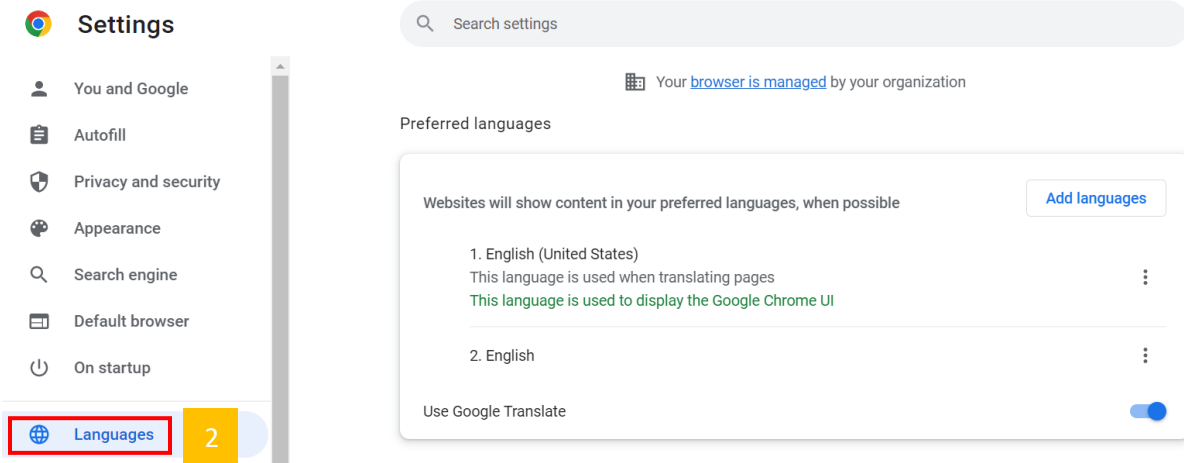

3

Select **Add Languages** > **Select your desired language** > **Click Add**

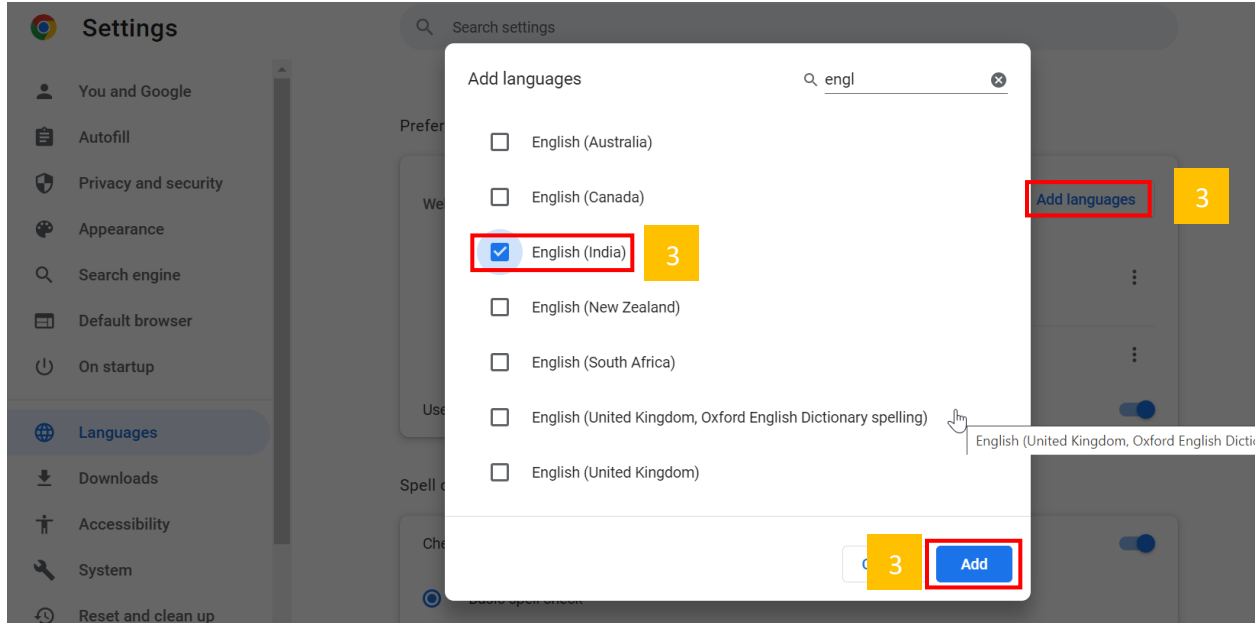

4

Click '...'

Websites will show content in your preferred languages, when possible [Add languages](#)

1. English (United States) 4 ⋮  
 This language is used when translating pages

---

2. English ⋮  
 This language is used to display the Google Chrome UI

---

3. English (India) ⋮

Use Google Translate

**5** Select **Display Google Chrome in this language**

Preferred languages

Websites will show content in your preferred languages, when possible 5 [Add languages](#)

1. English (United States) Relaunch ⋮  
 This language is used when translating pages  
 This language is used to display the Google Chrome UI

---

2. English 

Display Google Chrome in this language 5

  
 Offer to translate pages in this language

---

3. English (India)

Use Google Translate

Spell check

Move to the top

Move down

Remove

Next, close your browser and reopen it for the changes to take effect. If the language you select is not supported by SAP Business Network, it defaults to English.

**SAP Business Network support the following languages:**

English (en), French (fr), Italian (it), German (de), Spanish (es), Japanese (jp), Simplified Chinese (zh-cn), Traditional Chinese (zh-tw), Brazilian Portuguese (pt-br), Korean (ko), Russian (ru), Polish (pl), Hungarian (hu), Turkish (tr), Dutch (nl), Swedish (sv), Greek (el), Romanian (ro), Norwegian (no), Danish (da), Finnish (fi).

**Additional Information**

Any changes made to your browser language does not affect the language you specify for email notifications.